

CHILDREN'S 150N

INHERENTLY BUOYANT AND HYBRID AIR FOAM LIFEJACKETS

Owners Manual

IMPORTANT: PLEASE READ THIS MANUAL
BEFORE USING YOUR LIFEJACKET



BS EN ISO 12402-3:
2006+A1:2010





150N CHILDRENS LIFEJACKET

This level 150N lifejacket will give a reasonable assurance of safety from drowning to a person who, for whatever reason, is no longer capable of helping themselves fully. This level is intended for general application or for use with foul weather clothing. It will turn an unconscious person into a safe position and requires no subsequent action by the user to maintain this position. This jacket is suitable for offshore use.

IMPORTANT INFORMATION

- Train yourself in the use of this device



CHILDREN'S 150N

INHERENTLY BUOYANT AND HYBRID AIR FOAM LIFEJACKETS

Introduction To Lifejackets

Supersafe 150N Air	Page 4
Supersafe 150N	Page 5

Lifejacket Donning

Fitting Instructions	Page 6
Donning Supersafe 150N Air And Supersafe 150N	Page 7

Lifejacket Features

Using Inflation Tube On Inflatable Lifejackets	Page 8
Deflating Yourlifejacket After Use.....	Page 9
Repacking Your Supersafe 150N Air	Page 9
Using Safety Lines With A Harness Lifejacket	Page 10
Optimal Performance Information	Page 11

Care & Maintenance

General Care & Maintenance	Page 12
Periodical Checks.....	Page 12

Testing Your Lifejacket

Testing Your Lifejacket	Page 13
-------------------------------	---------

Warranty & Servicing

Servicing Your Lifejacket	Page 14
3 Year Warranty	Page 15





LARGE CHILD

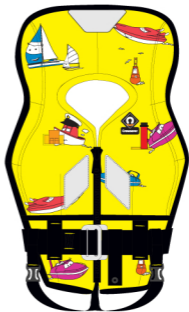

CHILD & BABY

SUPERSAFE +AIR 150N

- BS EN ISO 12402-3 approved
- Provides 150N of buoyancy
- Supersoft foam
- Exceptional turning speeds
- Increased mouth freeboard
- Built-in safety harness with built in D-ring at the back
- Baby and Child sizes have additional seat support
- Crotch straps fitted as standard
- Comfort back brace
- Additional manual inflation chamber to increase buoyancy
- Reflective tape
- Lifting Becket
- Whistle
- Strong, durable cover and fittings
- Adjustable waist
- Front zip





LARGE CHILD

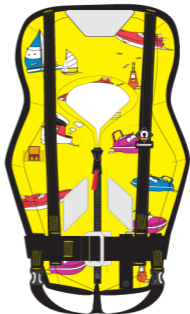

CHILD & BABY

.....
SUPERSAFE 150N







SUPERSAFE 150N

- BS EN ISO 12402-3 approved
- Provides 150N of buoyancy
- Supersoft foam
- Exceptional turning speeds
- Increased mouth freeboard
- Built-in safety harness with built in D-ring at the back
- Baby and Child sizes have additional seat support
- Crotch straps fitted as standard
- Reflective tape
- Strong, durable cover and fittings
- Adjustable waist
- Whistle
- Front zip



FITTING INSTRUCTIONS

See chart to check size, weight and buoyancy range. Also deck safety line suitability.

 ISO 12402-3:2006+A1:2010 LEVEL 150 PDF APPROVED PRODUCTS 	LIFEJACKET MODEL				FOAM 	+ AIR 	DECK SAFETY HARNESS ISO 12401: 2009.
	SUPERSAFE 150 AIR	BABY	40-50cm	<15kg	45N	60N	✓ <30kg
		CHILD	45-60cm	15-30kg	60N	75N	✓ <30kg
LARGE CHILD		55-70cm	30-40kg	75N	100N	✓ 30-50kg	
SUPERSAFE 150	BABY	40-50cm	<15kg	45N	-	✓ <30kg	
	CHILD	45-60cm	15-30kg	60N	-	✓ <30kg	
	LARGE CHILD	55-70cm	30-40kg	75N	-	✓ 30-50kg	

There is a whistle located in a small pocket on the front of the jacket cover. Six long blasts repeated at intervals is the International Distress Signal.

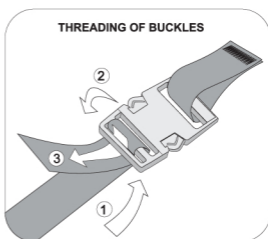
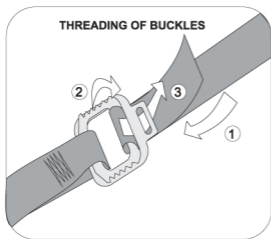

SUPERSAFE + AIR 150N SUPERSAFE 150N

DONNING THE SUPERSAFE 150N AIR AND SUPERSAFE 150N

- 1 Don like a normal jacket and fasten the zip to the top.
- 2 Fasten the front buckle(s) then adjust the webbing to provide a close, secure fit.
- 3 Fasten crutch straps to a close secure fit.

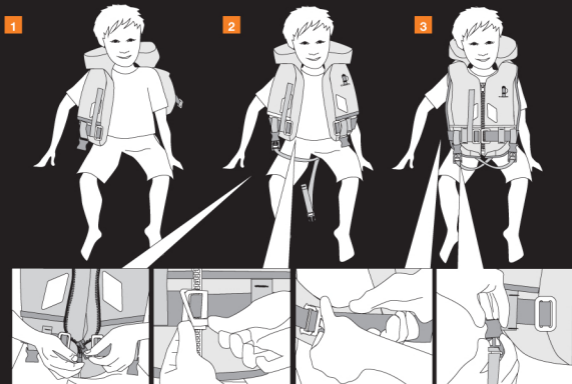

USING INFLATION TUBE ON INFLATABLE LIFEJACKETS

SUPERSAFE 150N AIR MODEL ONLY.

- 1 Remove the valve cap (a) at the top of the inflation tube (b).
- 2 Blow into the inflation tube. The protective cover on the lifejacket will unfold as the inflation chamber takes shape. To make this easier open up the cover by hand and continue to blow into the tube until it is difficult to inflate further.
- 3 Ensure once inflated that you replace the valve cap (a). It is important to keep this in place, except when the deflation valve is being used.

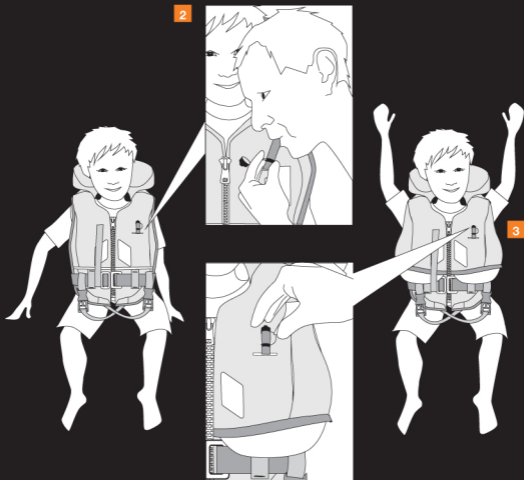
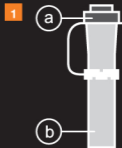

DEFLATING YOUR LIFEJACKET AFTER USE

- 1 Reverse the valve cap (a) at the top of the inflation tube and hold it in the valve.
- 2 Squeeze the lifejacket to expel the air inside.
- 3 Replace the valve cap (a) back into the normal position on top of the inflation tube. The lifejacket should now be completely deflated, and can be folded into the cover as before.



WARNING: DO NOT use anything other than the valve cap to deflate your lifejacket! Any other item used may cause damage to the valve. Over inflation can damage your lifejacket.



REPACKING YOUR SUPERSAFE 150N AIR

- 1 Ensure oral tube is protruding from the slot in the cover.
- 2 Fold inflater in and up inside the cover.
- 3 Fold over the velcro fastening strips to secure the cover

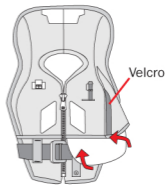

USING SAFETY LINES WITH A HARNESS LIFEJACKET

Crewsaver have a range of Safety Lines available that can be used with the lifejackets shown in this manual. Crewsaver currently stock 1 hook, 2 hook and 3 hook lines.



Crewsaver currently stock the following safety lines:

- A **1 hook self locking safety line** for children and infants.
- A **2 hook line** is used to connect to a strong point or jack stay ensuring that you are attached safely, during adverse conditions or to ensure your Security.
- A **3 hook safety line** to enable the transfer from a jack stay or a secure position to another secure position without jeopardising safety as a hook can always be attached to a strong point during transfer.

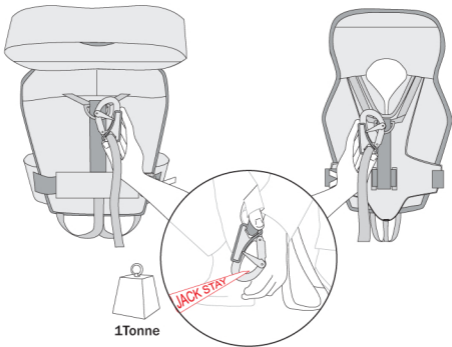

WARNING: The deck safety harness and safety line are intended to prevent the user falling overboard. They do not provide protection against falls from a height.





WARNING: The deck safety harness and safety line may transmit very large forces, attach to strong hooking points.



WARNING: It is unsafe to wear a harness loose, the harness shall be worn tightly in order to be effective.



WARNING: If your harness and/or safety line are subjected to an exceptional load while worn, it is vital that these are returned to Crewsaver for inspection. Even if no external damage is visible.



OPTIMAL PERFORMANCE INFORMATION



Full performance may not be achieved using waterproof clothing or in other circumstances. Certain circumstances will alter this performance, such as waves or the wearing of garments which provide additional buoyancy. The buoyancy provided by the jacket can be affected if heavy objects are carried in the pockets. The PFD will only function correctly with all the foam pads inserted.



Warning: Do not apply diapers which provide buoyancy when using the lifejacket. (This only applies to users with a body mass up to 15kg)



All closed cell foams will slowly lose a proportion of their buoyancy as the foam ages. This means that after a number of years, especially if it has been carelessly used or stored, the PFD may no longer provide the approved amount of buoyancy required at the time of manufacture. When three years old it should be tested annually, if the buoyancy falls below the following minimum buoyancy it should be replaced.

SIZE	BABY	CHILD	LARGE CHILD
FOAM 	45N	60N	75N
+ AIR 	60N	75N	100N

This Jacket has been tested to meet a temperature range between -30°C and 60°C as required by BS EN ISO 12402.

GENERAL CARE & MAINTENANCE

- Check your PFD every time you put it on.
- Examine it carefully to see that the belt is securely attached and if there is a zip that it is in working order.
- Pay particular attention of the straps, webbing and stitching for signs of abrasion or damage.
- Periodically rinse the lifejacket in fresh water, particularly if it has been in contact with salt water.
- After rinsing, allow the lifejacket to dry naturally before stowing in a dry place.
- Oil or other similar marks should be removed by washing with warm soapy water.
- Never clean your lifejacket in a washing machine or dry it in a tumble dryer.
- Do not use as a cushion.



PERIODICAL CHECKS

Check the fabric for cuts, tears, abrasion and signs of damage caused by heat.

Leak testing is an important part of the periodical checks, inflate your lifejacket orally until firm. Leave overnight or for a minimum of 12 hours. A lifejacket that is leaking will not hold its firmness and must be replaced. If your lifejacket leaks please contact Crewsaver for assistance. Repack your lifejacket using the repacking instructions in this manual.

NOTE: Avoid wide variations in temperature when performing this test! Temperature variation can cause the inflatable chamber to loose firmness.



TESTING YOUR LIFEJACKET

In an emergency, there is no time to learn how equipment works. Crewsaver recommend that you try your lifejacket to ascertain its performance before use in an emergency. This will also help familiarise yourself with the product. Teach the child to float in this lifejacket. Children should be encouraged to learn how to put their lifejacket on for themselves.

If you are a weak swimmer it is strongly recommended that you use an inherently buoyant device or an automatically operated lifejacket.

TRAIN YOURSELF IN THE USE OF THIS DEVICE

- Step 1:** Put on your lifejacket by following - see Pg 7, Donning Your Lifejacket. It is important to adjust the belt on a lifejacket to achieve a close fit. This reduces the possibility of the lifejacket riding-up in the water.
- Step 2:** Stand in shallow water, ensuring that the water is just deep enough for your head to be above the water's surface.
- Step 3:** **SUPERSAFE 150N AIR MODEL ONLY.** Inflate the additional chamber of the lifejacket by locating the oral inflation tube, remove the cap and blow into the tube. Open the cover if this makes it easier to inflate.

The **SUPERSAFE150N** model **DOES NOT** require inflation as it only has inherent foam buoyancy.

Once inflated see how the lifejacket holds you in the water, noting the position that it holds you in, with your mouth well clear of the water's surface and your body at an angle.

Your lifejacket should be tested whilst wearing offshore clothing. Check that the lifejacket will turn you from a face down position to a face up position.

NOTE: Some offshore clothing in particular drysuits and immersion suits can trap air - this may affect the performance of the lifejacket.

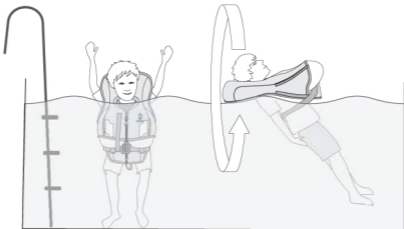

YOUR 3 YEAR GUARANTEE

Crewsaver has over 50 years' experience in manufacturing safety equipment and our total commitment to quality enables us to offer you a **FULL 3 YEAR GUARANTEE** on your lifejacket.

This 3 year guarantee includes all parts and labour to repair defective equipment and the return postage.

The guarantee covers all Crewsaver lifejackets and combined lifejackets/harnesses worn for normal leisure purposes. This excludes commercial and industrial use and other applications where equipment is either worn for prolonged periods or in severe conditions.

The guarantee does not cover the effects of accidental damage, normal wear and tear, or mistreatment, or where repairs have been carried out other than by a Crewsaver approved serviced centre.

The guarantee covers all lifejackets registered via the Crewsaver website, any products returned that are not registered with Crewsaver will not be considered for warranty.

Remember your lifejacket is an important piece of safety equipment and should be serviced annually. Servicing should be completed with genuine Crewsaver parts at a Crewsaver approved service station. Crewsaver will not accept any lifejackets for warranty that have not been serviced annually at a Crewsaver approved service station.

Please copy the **Product Serial Number** and **Date Purchased** below for your own reference:

SERIAL NO:

DATE PURCHASED:

For more information or to register your product please visit our website www.crewsaver.com

SERVICE ANNUALLY

Your lifejacket must be serviced on an annual basis.

Never try to repair a lifejacket yourself. You could cause more damage and render the lifejacket irreparable or affect the warranty.

Always return the lifejacket to a Crewsaver approved service station for repairs and servicing.

To find your nearest Crewsaver approved service station visit:
crewsaver.com/findastockist



SIZE	CHEST	WEIGHT	BUOYANCY
TAILLE	TOUR DE POITRINE	POIDS	FLOTTABILITE
GRÖSSE	BRUSTUMPFANG	GEWICHT	AUFTRIEB
MAAT	BORSTOMVANG	GEWICHT	DRIJFVERMOGEN
STØRRELSE	BRYSTVIDDE	VEKT	OPDRIFT
KOKO	RINTAKEHÄN YMPÄRYSMITTA	PAINO	KANTAVUUS
STØRRELSE	BRYSTSTØRRELSE	VÆGT	OPDRIFT
STORLEK	BRÖSTVIDD	VIKT	LYFTKRAFT
TAGLIA	MISURE DI PETTO	PESO	SPINTA GALLEGGIANTE
TAMANHO	TAMANHO DO PEITO	PESO	FLUTUAÇÃO

ART0039i6

 **survitecgroup**

Crewsaver, Survitec House
Lederle Lane, Gosport
Hampshire
PO13 0FZ
UNITED KINGDOM

Tel: +44 (0) 1329 8200 00
Fax: +44 (0) 1329 2362 18

www.crewsaver.com

Crewsaver, Units A, F & G
75 St Hilliers Road
Auburn NSW 2144, PO Box 6091
Silverwater BC 1811
AUSTRALIA

Tel: +61 2 9330 7000
Fax: +61 2 9330 7098



Crewsaver®